

Property Exhibit

of
Tax Parcel BSW 00022,

located in the Northwest 1/4 of Section 10, Town 2 North, Range
15 East, Town of Darien, Walworth County, Wisconsin.

Legal Description
A parcel of land described in a Warranty Deed recorded March 1, 2012 as Document
No. 833124 as shown below:

That part of the North 1/2 of the Northwest 1/4 of Section 10, T2N, R15E, in the
Town of Darien, Walworth County, Wisconsin, bounded and described as follows:

Commencing at the Southwest corner of the North 1/2 of said Northwest 1/4 Sec-
tion; thence North 89° 52' 30" East, along the South line of the North 1/2 of said
1/4 Section, 1285.64 feet to the point of beginning; thence North 29° 05' 15" West
600.19 feet to a point on a curve whose center lies to the Northwest with a radius
of 383.00 feet and a chord bearing North 25° 50' 00" East 143.97 feet; thence
Northeasterly along the arc of said curve, 144.84 feet; thence South 75° 00' 00"
East, 571.80 feet; thence South 14° 22' 14" West, 521.94 feet to the South line of
the North 1/2 of said 1/4 Section; thence South 89° 52' 30" West, 193.65 feet to the
place of beginning, and being sometimes known as Lot 22 of Springwood Farm, an
unrecorded subdivision.

ALSO

That part of the North 1/2 of the Northwest 1/4 of Section 10, T2N, R15E, in the
Town of Darien, Walworth County, Wisconsin, bounded and described as follows:
Commencing at the Southeast corner of the North 1/2 of said Northwest 1/4 Section;
thence South 89° 52' 30" West, along the South line of the North 1/2 of said North-
west 1/4, 1155.74 feet; thence North 14° 22' 14" West 936.75 feet; thence East,
20.65 feet; thence South 14° 22' 14" West, 419.95 feet; thence South 75° 00' 00"
East 521.13 feet; thence North 77° 30' 00" East, 523.57 feet to the East line of
said Northwest 1/4; thence South 00° 55' 41" West, along said East line, 476.63
feet to the point of beginning, and being sometimes known as Outlot B of Spring-
wood Farm, an unrecorded subdivision.

Surveyed for: **Frank Longenecker**
W8491 Springwood Drive
Delavan, Wisconsin. 53115

Tax Parcel
BSW 00025

Tax Parcel
BD 1000002A

Tax Parcel
BD 1000005A

Copyright 2013 by Jensen & Olson Land Surveying, LLC.

All rights reserved. No part of this survey plat may be reproduced or transmitted in
any form by any means - graphic, electronic, or mechanical, including photocopying,
tracing, or information storage and retrieval systems - without permission in writing
from Douglas G. Olson, Jensen & Olson Land Surveying, LLC.

I, Douglas G. Olson, Wisconsin Registered Land Surveyor, do hereby certify
that this survey was performed by me, or under my direction in full compliance with
the owner's/agent's instructions and Chapter A-E 7 of the Wisconsin Administrative
Code "Minimum Standards for Property Surveys"; and that this map is an accurate
representation thereof to the best of my knowledge and belief.

Douglas G. Olson
Wisconsin Registered Land Surveyor - 2093

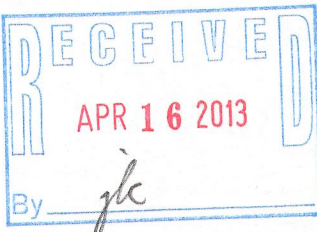

Sunshine Lane

(66' Wide)

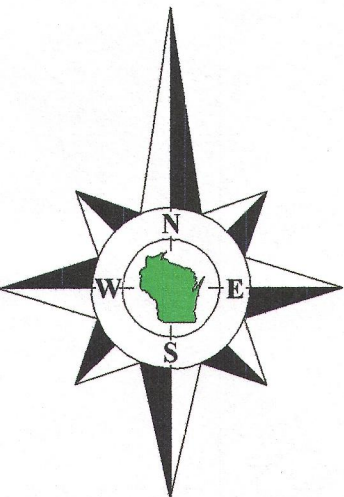

Bearings reference to previous
surveys of record.

Tax Parcel
BSW 00024

Tax Parcel
BSW 00022
(16.731 Acres)

Outlot B
Unrecorded
Springwood Farm
(11.054 Acres)

Turtle Creek

Springwood Drive

(66' Wide)

Tax Parcel
BSW 00023

Lot 22
Unrecorded
Springwood Farm
5.684 Acres
247,579 Sq.Ft.

Tax Parcel
BSW 00021

Tax Parcel
BD 1000004B

Notes:

- 1) This survey plat is not
certified unless signed
and sealed in red ink.
- 2) This survey is subject to Wisconsin lien laws.
This Plat of Survey is the notice of intent
to file lien. Lien waiver required.

Note:

The location of Turtle Creek is shown as imported
from the Walworth County digital mapping.

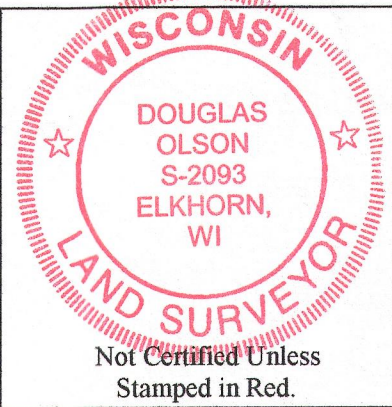

Survey date: January 8, 2013.

Revisions:

Scale in Feet

1" = 60'



Jensen & Olson Land Surveying, LLC

45 South Wisconsin Street * P.O. Box 322 * Elkhorn, Wisconsin. 53121
Telephone: (262) 723-3434 * Facsimile: (262) 723-8044
Email: jensen.olson@elknet.net

Legend

- Found Iron Pipe
- Set Iron Rod, 1/2" dia.
- Recorded Information

Sheet 1 of 1 Sheets

Drawing Name: Chart 15-2012019-2012019Exhibit-03

Job Reference Number

2012.019

2012.019